

















-  FC-1 MOHAWK GROUP, ZIP IT, SKINNY 995 (12"x36" herringbone install - main field color)
-  FC-2 MOHAWK GROUP, COLOR BEAT, SCARLET 374 (12"x36" - accent carpet)
-  F-3 ARMSTRONG EXCELON, IMPERIAL TEXTURE, PEWTER 51908 (12"x12")
-  F-1 SAVOIA, DELUXE OCEAN STORM IRL 1224018, LUSTER (24"x24" @ 45 degrees w/ Mapei #47 Charcoal grout)
-  F-2 SAVOIA, DELUXE DELORIAN GREY IRL 1224011, LUSTER (12"x24" w/ Mapei #47 Charcoal grout)
-  F-2 SAVOIA, DELUXE DELORIAN GREY IRL 1224011, LUSTER (12"x24" w/ Mapei #47 Charcoal grout - w/ Crack Isolation Membrane)
-  CT-1 MARAZZI ARCHITETTURA - ME90 (4"x4" - w/ Mapei #47 Charcoal)
-  CT-2 MARAZZI ARCHITETTURA - ME9Y (4"x4" - w/ Mapei #47 Charcoal)
-  CT-3 MARAZZI ARCHITETTURA - ME9X (4"x4" - w/ Mapei #47 Charcoal)
-  BC-1 BASE TO MATCH CARPET FC-1
-  BV-1 4" JOHNSONITE RUBBER WALL BASE, COVERED, COLOR TBD
-  BT-1 TILE BASE TO MATCH F-2, TBD
-  TS-1 CARPET TO VCT TRANSITION, TBD
-  TS-2 VCT TO CONCRETE TRANSITION, TBD
-  TS-3 CARPET TO CONCRETE TRANSITION, TBD
-  TS-4 TILE TRANSITION, TBD (at floor)
-  TS-5 WALL TILE CAP, TBD (at top of wainscot)

Scale 1:650 (original drawing scale 1:48)

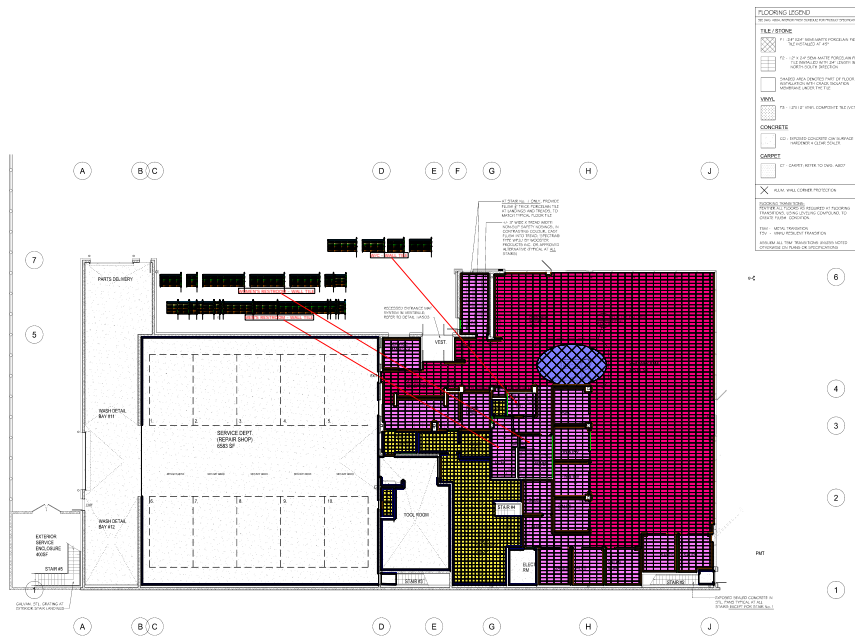

bfa
BESHARAT FRIARS
ARCHITECTS

PROJECT: NORTHSHORE KIA
DATE: 12/02/2014

ISSUED FOR TENDER
02 DEC 2014

A805

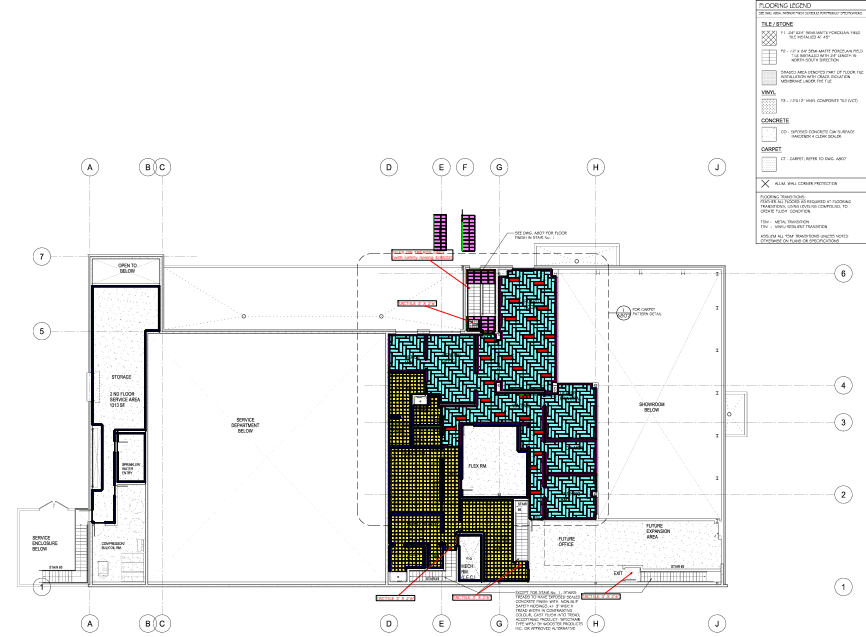

bfa
BESHARAT FRIARS
ARCHITECTS

PROJECT: NORTHSHORE KIA
DATE: 12/02/2014

ISSUED FOR TENDER
02 DEC 2014

A806